



Refrigerating systems and aggregates

Catalogue of the
professional commercial
refrigeration equipment

Model range 2019

MXM
m a r i k h o l o d m a s h
www.mariholod.com

ABOUT US4

Condensing units 7

Refrigerating chambers11

Glass doors for refrigerated showcases17

Monoblock units21

Split systems 27

Beer Chilling Units31

Refrigerated counters 35



ABOUT US

The history of the Marikholodmash trademark dates back to the founding of the commercial machine-building plant in 1941 (evacuated from Kiev) that specialized in the production of shells, shop scales and other shop equipment.

Since 1960, the plant has specialized in the production of commercial refrigeration equipment. It was this plant that produced the first homemade refrigerating cabinets and refrigerating chambers. Over the years, several kinds of commercial refrigeration equipment have been developed and introduced into production.

The Tair refrigerated showcase has been produced since 1970. The showcase underwent many modernizations and design changes; it is developed in line with the latest technologies in commercial refrigeration equipment so that it is in constant demand.

Our company produced equipment for such facilities as: the Kremlin Palace of Congresses, the Ostankino Tower restaurant, the first Russian self-service shops.

Currently, the Marikholodmash trademark is produced by Contact JSC, which has preserved all the best traditions, improved quality and expanded the product range.

Currently, the Contact Plant offers a wide range of modern commercial refrigeration equipment. The product lines of refrigerated showcases are placed on the market - Ilet, Tair, Nova, Kupets and Veneto.

In 2012, the plant launched a new series of medium-temperature refrigerating cabinets under the name of Capri. For their production, a modern metalworking line manufactured by Salvagnini (Italy) and a line for the production of cabinets manufactured by Meccanica NAI (Italy) were mounted and launched.

Besides, the plant manufactures other equipment for trade such as: refrigerated counters, checkout counters, racks, refrigerated showcase and multidecks.

Thanks to the use of modern technologies, the products manufactured by the Contact Plant have:

- high quality;
- reliability and operational convenience;
- modern design;
- competitive price

Besides, the plant manufactures other equipment for trade such as: refrigerated counters, checkout counters, racks, refrigerated showcase and multidecks.

Those who buy our equipment can be sure that they purchase products that meet the most modern requirements and have an excellent price-quality ratio.

The equipment manufactured by Contact, in contrast to most other commercial refrigeration equipment manufacturers, operates at ambient temperature over 35 C that undoubtedly emphasizes its reliability.

The use of modern powder paints and their application on an automatic programmed painting line provides a beautiful appearance of commercial refrigeration equipment and surface protection against corrosion.

The plant produces electroplating parts on the Italian automated programmed line.

The complete safety of commercial refrigeration equipment during loading, transportation and storage is guaranteed by specially designed packaging.



CONDENSING UNITS

BKK ZB26 is made on the basis of a spiral medium-temperature compressor produced by Copeland, Danfoss.

Refrigeration compressors, a high-performance air-cooled condenser with an electronic fan speed controller and a liquid receiver are installed on a steel base.

Complete set:

- sight glass - moisture content indicator;
- anti-resistant filter drain;
- filter drain protecting the compressor from mechanical particles and moisture

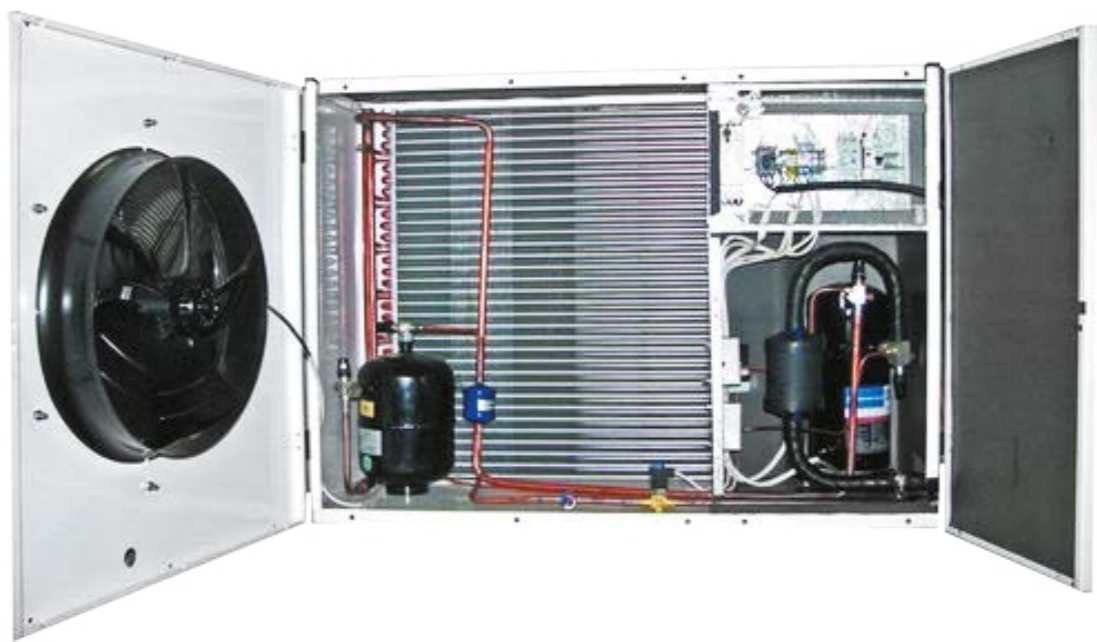

BKK	ZF 13	ZB 15	ZB 19
at ambient temperature, °C	-40...+45		
refrigeration capacity, kW	2,47	3,52	3,97
absorbed power, kW, maximum	2,33	1,85	2,19
receiver volume, l, minimum	7		
width without protruding parts, mm	1190		
width with protruding parts, mm	1260		
depth without protruding parts, mm	400		
depth with protruding parts, mm	560		
height, mm	900		

Logistic information

net, kg110
gross, kg160
packing width, mm1370
packing depth, mm690
packing height, mm1070

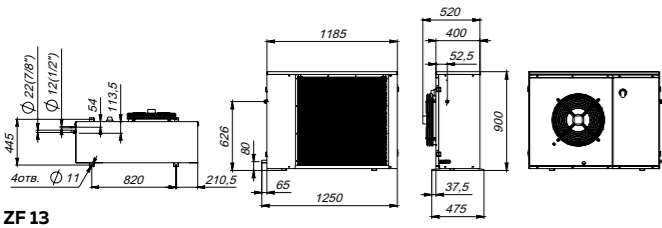

ZF 13

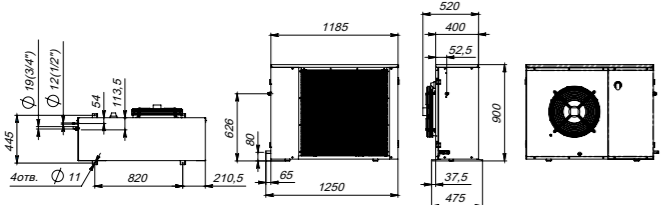

ZB 15 ZB 19

BKK ZB	ZB 21	ZB 26	ZB 30
at ambient temperature, °C	-40...+45		
refrigeration capacity, kW	4,71	5,60	6,14
absorbed power, kW, maximum	3,72	3,24	3,88
receiver volume, l, minimum	7		
width without protruding parts, mm	1190		
width with protruding parts, mm	1260		
depth without protruding parts, mm	400		
depth with protruding parts, mm	560		
height, mm	900		

Logistic information

net, kg110
gross, kg160
packing width, mm1370
packing depth, mm690
packing height, mm1070

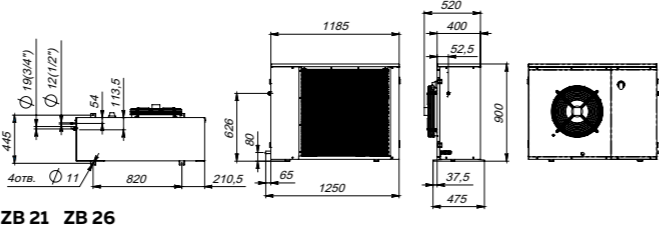

ZB 21 ZB 26

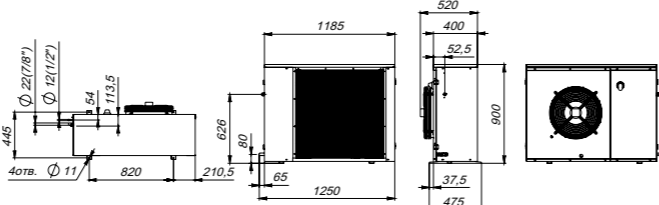

ZB 30

BKK ZB	ZB 38	ZB 45	ZB 48
at ambient temperature, °C	-40...+45		
refrigeration capacity, kW	7,8	9,28	9,89
absorbed power, kW, maximum	4,7	5,44	5,80
receiver volume, l, minimum	7		
width without protruding parts, mm	1435		
width with protruding parts, mm	1500		
depth without protruding parts, mm	400		
depth with protruding parts, mm	560		
height, mm	900		

Logistic information

net, kg ZB38 - 135; ZB46, ZB48 - 140
gross, kg190
packing width, mm1620
packing depth, mm690
packing height, mm1070

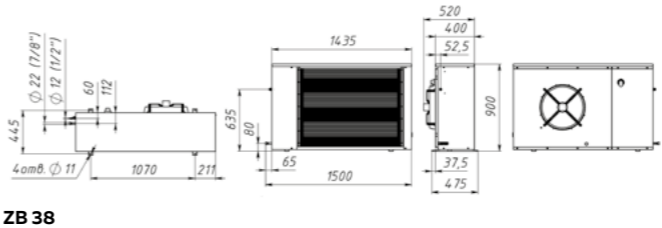

ZB 38

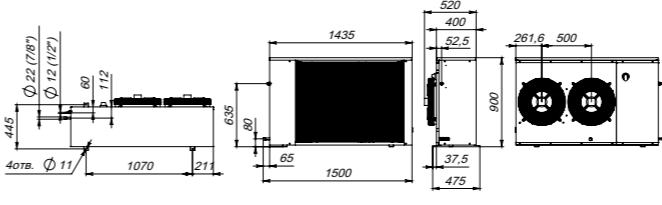

ZB 45 ZB 48

BKK ZB	ZB 58	ZB 66
at ambient temperature, °C	-40...+45	
refrigeration capacity, kW	12,70	14,0
absorbed power, kW, maximum	6,84	7,8
receiver volume, l, minimum	12,5	
width without protruding parts, mm	1435	1790
width with protruding parts, mm	1515	1860
depth without protruding parts, mm	400	
depth with protruding parts, mm	560	
height, mm	1100	

Logistic information

net, kg ZB58 - 170; ZB66 - 200
gross, kg2000
packing width, mm1620
packing depth, mm960
packing height, mm1270

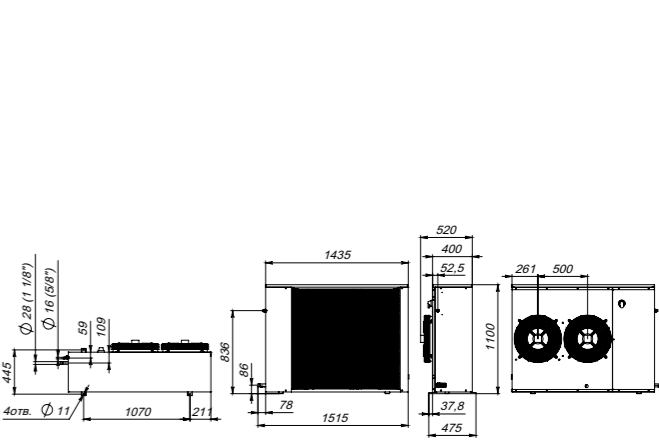

ZB 58 ZB 66



REFRIGERATED CHAMBERS

Dismountable chambers made of foam polyurethane sandwich panels tongued and grooved, 80 mm and 100 mm in thickness. The panel manufacturing equipment was supplied by leading manufacturers of Cannon, Manny (Italy). Thanks to the dismountable design, the refrigerating chamber can be transformed by adding new panels and dismantled without disrupting the tightness of the joints. The door accessories are supplied by the leading manufacturer MTH (Italy).

Standard complete set:

- painted (RAL 9003) galvanized steel with protective film to be removed after installation;
- floor panels coated with galvanized steel 1 mm in thickness;
- medium-temperature single swing door with a light opening 800x1850 mm in size;
- handle-lock with emergency opening device;
- set (key, caps, and fasteners)



SET OF PANELS KH

8,81

connection type	tongue and groove
panel thickness, mm	80
volume, m³	8,81
width, mm	1960
depth, mm	2560
height, mm	2200

Logistic information

net, kg	500
gross, kg	550
packing width, mm	1370
packing depth, mm	2200
packing height, mm	1310



SET OF PANELS KH

7,71

connection type	tongue and groove
panel thickness, mm	80
volume, m³	7,71
width, mm	1960
depth, mm	2260
height, mm	2200

Logistic information

net, kg	450
gross, kg	500
packing width, mm	1370
packing depth, mm	2200
packing height, mm	1230



SET OF PANELS KH

6,61

connection type	tongue and groove
panel thickness, mm	80
volume, m³	6,61
width, mm	1960
depth, mm	1960
height, mm	2200

Logistic information

net, kg	400
gross, kg	450
packing width, mm	1370
packing depth, mm	2200
packing height, mm	1070



SET OF PANELS KH

4,41

connection type	tongue and groove
panel thickness, mm	80
volume, m³	4,41
width, mm	1960
depth, mm	1360
height, mm	2200

Logistic information

net, kg	350
gross, kg	400
packing width, mm	1370
packing depth, mm	2200
packing height, mm	1071



SET OF PANELS KH

2,94

connection type	tongue and groove
panel thickness, mm	80
volume, m³	2,94
width, mm	1360
depth, mm	1360
height, mm	2200

Logistic information

net, kg	300
gross, kg	350
packing width, mm	1370
packing depth, mm	2200
packing height, mm	1020



SET OF PANELS KH

11,75

connection type	tongue and groove
panel thickness, mm	80
volume, m³	11,75
width, mm	2560
depth, mm	2560
height, mm	2200

Logistic information

net, kg	800
gross, kg	850
packing width, mm	1370
packing depth, mm	2700
packing height, mm	1390



SET OF PANELS KH

11,02

connection type	tongue and groove
panel thickness, mm	80
volume, m³	11,02
width, mm	1960
depth, mm	3160
height, mm	2200

Logistic information

net, kg	700
gross, kg	750
packing width, mm	1370
packing depth, mm	2700
packing height, mm	1470



GLASS DOORS FOR REFRIGERATING AND FREEZING SHOWCASES

Marikholodmash offers glass doors for commercial and industrial use. The products comply with the latest technology, as well as all technical safety requirements.

Frame:

- anodized aluminium frame, profiles with cold-breaking inserts;
- low-temperature version with electric heating

Doors:

- triple-pane glass;
- external door frame made of anodized aluminium with electric heating;
- ANTI-FOG film preventing from condensation

Accessories:

- magnetic sealing rubber;
- self-closing hinges;
- LED lighting

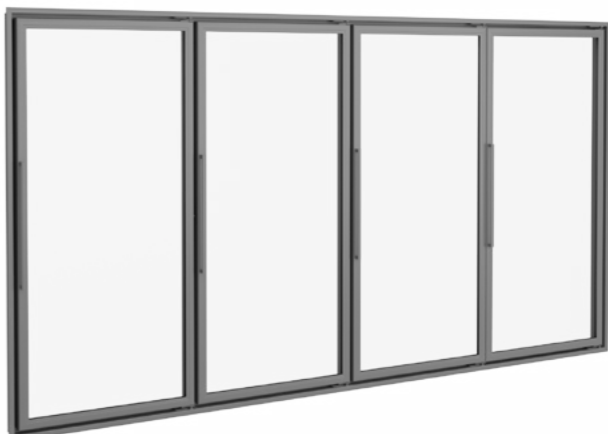
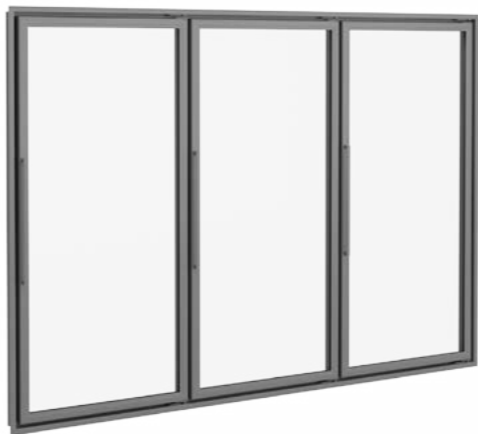

GLASS FRONT SIZE		700x1640
number of doors, pcs		1
width, mm		660
height, mm		1600
installation width, mm		700
installation length, mm		1640

Logistic information	
Place 1	
net, kg	5
gross, kg	25
packing width, mm	810
packing depth, mm	190
packing height, mm	1750
Place 2	
net, kg	30
gross, kg	70
packing width, mm	1845
packing depth, mm	490
packing height, mm	970

GLASS FRONT SIZE		1374x1640
number of doors, pcs		2
width, mm		660
height, mm		1600
installation width, mm		1374
installation length, mm		1640

Logistic information	
Place 1	
net, kg	6
gross, kg	35
packing width, mm	1485
packing depth, mm	190
packing height, mm	1750
Place 2	
net, kg	60
gross, kg	100
packing width, mm	1845
packing depth, mm	490
packing height, mm	970

GLASS FRONT SIZE		2048x1640
number of doors, pcs		3
width, mm		660
height, mm		1600
installation width, mm		2048
installation length, mm		1640

Logistic information	
Place 1	
net, kg	7,5
gross, kg	45
packing width, mm	2160
packing depth, mm	190
packing height, mm	1750
Place 2	
net, kg	90
gross, kg	130
packing width, mm	1845
packing depth, mm	490
packing height, mm	970

GLASS FRONT SIZE		2722x1640
number of doors, pcs		4
width, mm		660
height, mm		1600
installation width, mm		2722
installation length, mm		1640

Logistic information	
Place 1	
net, kg	8,5
gross, kg	55
packing width, mm	2840
packing depth, mm	190
packing height, mm	1750
Place 2	
net, kg	120
gross, kg	175
packing width, mm	1845
packing depth, mm	750
packing height, mm	970

The background of the page is an abstract, textured image with shades of blue and white, resembling a close-up of a rocky surface or a microscopic view of a material. The texture is irregular and organic, with various shades of blue ranging from light to dark, and white highlights that create a sense of depth and movement.

MONOBLOCKS

The MMN monoblocks (medium-temperature) and LMN monoblock units (low-temperature) are made in the climatic modification "U" of category 3 according to GOST15150 for operation at an ambient temperature of 12 to 45°C and relative humidity up to 80%.

The standard complete set of the monoblock includes: high-efficiency condenser, blower, compressor, filter drain, electric control unit, condensate collection and evaporation tank, copper aluminum evaporator, tubular electric heater of defrost evaporator, condensate collection tray.

During defrosting, the condensate is drained through a tube, heated by a heating conductor, into the condensate collection and evaporation tank.

The monoblock uses hermetic reciprocating compressor Danfoss and Tecumseh. A capillary tube is used as a throttling device. The compressor is protected by a high-pressure switch.

The Marikholodmash refrigeration monoblock is a high quality, reliability, convenient and easy operation, modern design and competitive prices. The Marikholodmash monoblocks are filled with a refrigerating agent and tested under factory conditions, which guarantees their safety and reliability.



MMN	106	108	110
chamber inside temperature,°C	maximum 0		
optimum chamber volume (t=80mm), m³	6	8	10
refrigerant medium	R404A		
number of refrigerant medium, g	350	380	360
daily electric energy consumption, kWh	9,0	11,0	13,0
refrigeration capacity, W	906	1034	1249
width, mm	455		
depth, mm	850		
height, mm	720		

Logistic information

net, kg106-45; 108-45; 110-46
gross, kg.....106-75; 108-76; 110-77
packing width, mm.....541
packing depth, mm.....956
packing height, mm.....869

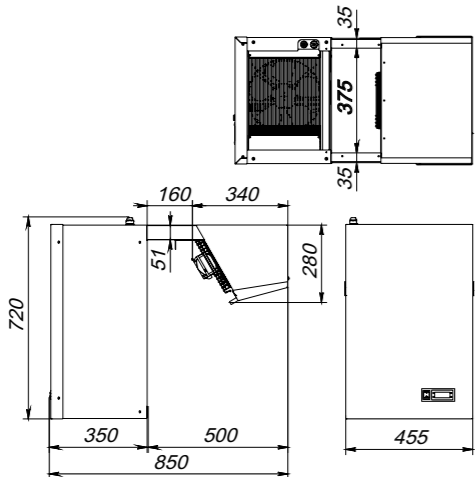

MMN	112	114
chamber inside temperature,°C	maximum 0	
optimum chamber volume (t=80mm), m³	12	14
refrigerant medium	R404A	
number of refrigerant medium, g	370	400
daily electric energy consumption, kWh	15,0	18,0
refrigeration capacity, W	1390	1559
width, mm	455	
depth, mm	850	
height, mm	720	

Logistic information

net, kg46
gross, kg.....78
packing width, mm.....541
packing depth, mm.....956
packing height, mm.....869

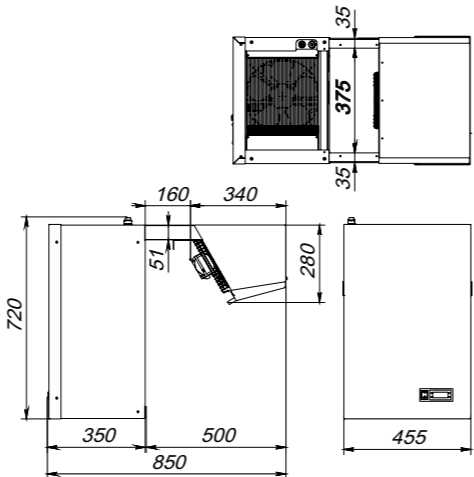

LMN	107	109
chamber inside temperature,°C	maximum -18	
optimum chamber volume (t=80mm), m³	7	9
refrigerant medium	R404A	
number of refrigerant medium, g	400	350
daily electric energy consumption, kWh	16,0	21,0
refrigeration capacity, W	1049	1270
width, mm	455	
depth, mm	850	
height, mm	720	

Logistic information

net, kg107-55; 109-56
gross, kg.....017-85; 109-86
packing width, mm.....541
packing depth, mm.....956
packing height, mm.....869

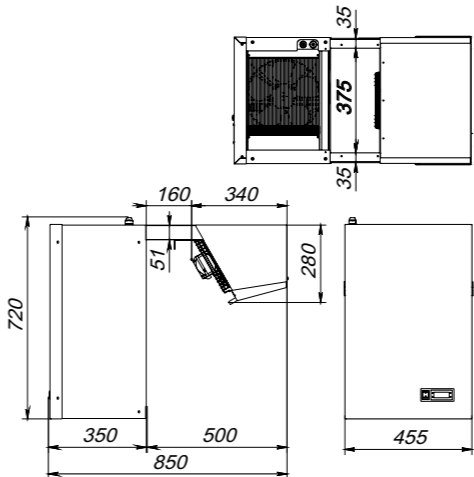

MMN	222	228
chamber inside temperature,°C	maximum 0	
optimum chamber volume (t=80mm), m³	22	28
refrigerant medium	R404A	
number of refrigerant medium, g	450	400
daily electric energy consumption, kWh	20,0	23,0
refrigeration capacity, W		
width, mm	735	
depth, mm	850	
height, mm	720	

Logistic information

net, kg222-67; 228-68
gross, kg.....222-92; 228-93
packing width, mm.....820
packing depth, mm.....960
packing height, mm.....870

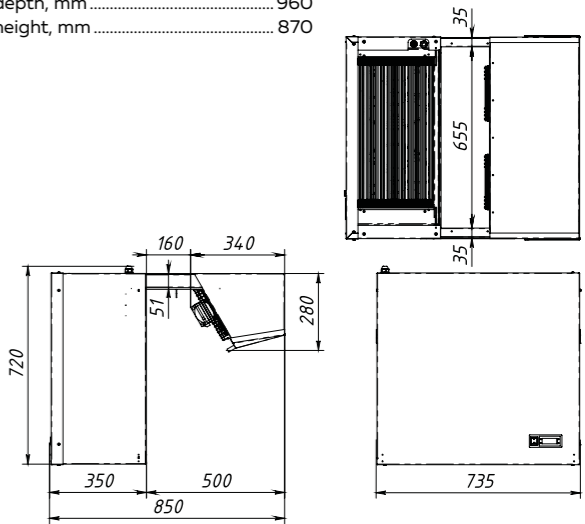



LMN	213	217
chamber inside temperature, °C	maximum -18	
optimum chamber volume (t=80mm), m³	13	17
refrigerant medium	R404A	
number of refrigerant medium, g	450	400
daily electric energy consumption, kWh	21,0	25,0
refrigeration capacity, W	1574	1961
width, mm	735	
depth, mm	850	
height, mm	720	

Logistic information

net, kg	213-69; 217-77
gross, kg	213-94; 217-102
packing width, mm	820
packing depth, mm	960
packing height, mm	870

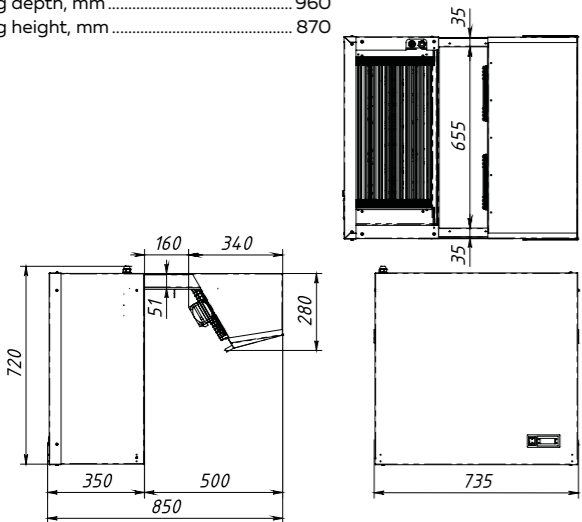

MMN	338	344
chamber inside temperature, °C	maximum 0	
optimum chamber volume (t=80mm), m³	38	44
refrigerant medium	R404A	
number of refrigerant medium, g	1500	1750
daily electric energy consumption, kWh	22,0	27,0
refrigeration capacity, W		
width, mm	1060	
depth, mm	851	
height, mm	960	

Logistic information

net, kg	338-87; 344-88
gross, kg	338-107; 344-108
packing width, mm	970
packing depth, mm	1170
packing height, mm	1180

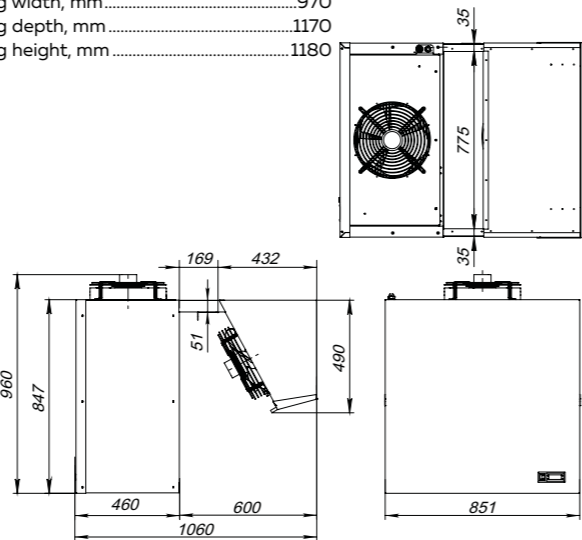

LMN 327	
chamber inside temperature, °C	maximum -18
optimum chamber volume (t=80mm), m³	27
refrigerant medium	R404A
number of refrigerant medium, g	1800
daily electric energy consumption, kWh	26,0
refrigeration capacity, W	2679
width, mm	1060
depth, mm	851
height, mm	960

Logistic information

net, kg	89
gross, kg	109
packing width, mm	970
packing depth, mm	1170
packing height, mm	1180

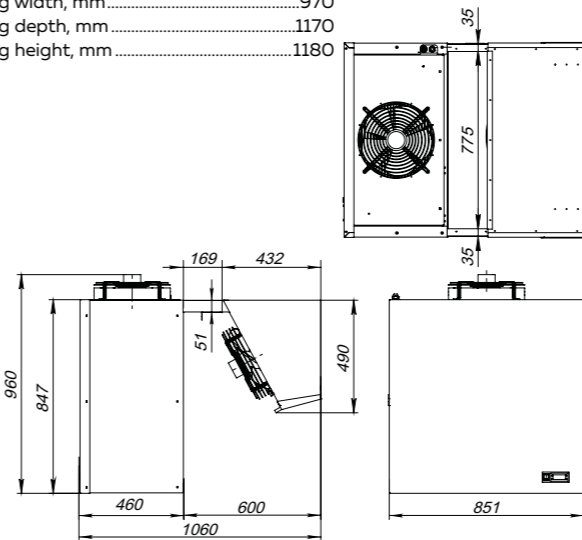

LMN 331	
chamber inside temperature, °C	maximum -18
optimum chamber volume (t=80mm), m³	31
refrigerant medium	R404A
number of refrigerant medium, g	1800
daily electric energy consumption, kWh	34,0
refrigeration capacity, W	3084
width, mm	1060
depth, mm	851
height, mm	960

Logistic information

net, kg	97
gross, kg	117
packing width, mm	970
packing depth, mm	1170
packing height, mm	1180

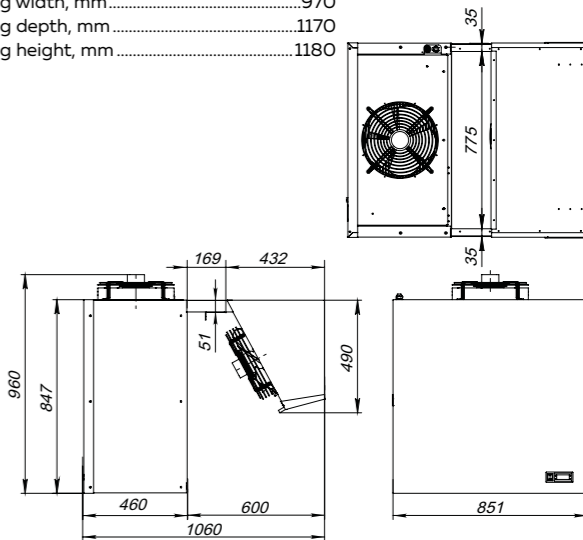



SPLIT SYSTEMS

Marikholodmash low-temperature split systems are designed to maintain the required temperature in freezers. The equipment operates at an ambient temperature of 12 to 45 °C and relative humidity of 80%

Additional features:

Condensers:

- number of fans: two;
- fan power: 0.016 kW / 1300 rpm;
- impeller diameter: 254 mm;
- productivity: 1400 m³/h

Air cooler:

- fin spacing: 5 mm;
- surface: 8 m²;
- number of fans: two;
- fan power: 0.01 kW/1300 rpm;
- impeller diameter: 200 mm;
- productivity: 1200 m³/h



MSN 222

chamber inside temperature, °C	maximum 0
number of refrigerant medium, g	450
daily electric energy consumption, kWh	20,0
size of compression-condensation part	
width, mm	801
depth, mm	343
height, mm	744
size of evaporative section	
width, mm	804
depth, mm	433
height, mm	284

Logistic information

net, kg	53/17
gross, kg	95
packing width, mm	820
packing depth, mm	960
packing height, mm	870

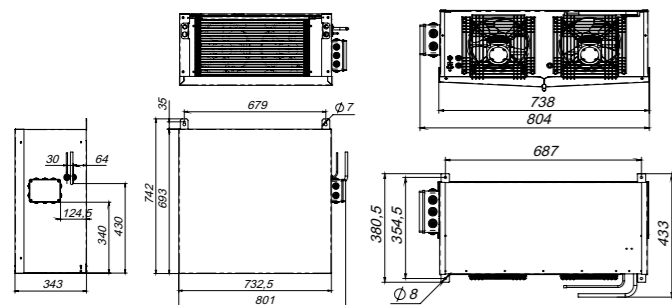
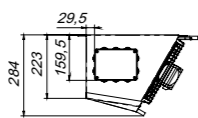

MSN 228

chamber inside temperature, °C	maximum 0
number of refrigerant medium, g	400
daily electric energy consumption, kWh	23,0
size of compression-condensation part	
width, mm	801
depth, mm	343
height, mm	744
size of evaporative section	
width, mm	804
depth, mm	433
height, mm	284

Logistic information

net, kg	53/17
gross, kg	95
packing width, mm	820
packing depth, mm	960
packing height, mm	870

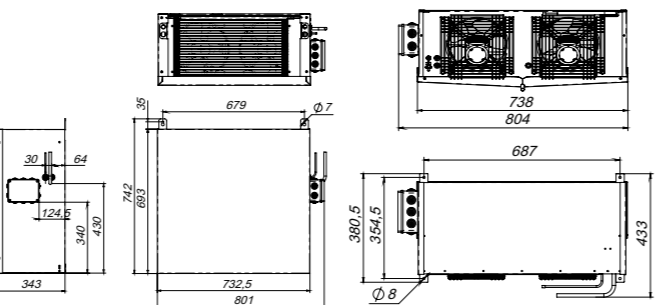
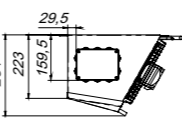

MSN 213

chamber inside temperature, °C	maximum -18
number of refrigerant medium, g	450
daily electric energy consumption, kWh	21,0
size of compression-condensation part	
width, mm	801
depth, mm	343
height, mm	744
size of evaporative section	
width, mm	804
depth, mm	433
height, mm	284

Logistic information

net, kg	55/17
gross, kg	97
packing width, mm	820
packing depth, mm	960
packing height, mm	870

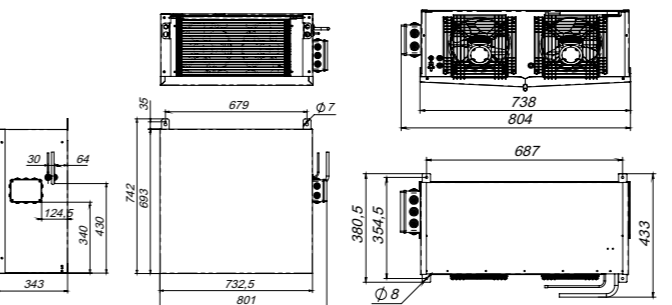
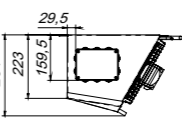

MSN 217

chamber inside temperature, °C	maximum -18
number of refrigerant medium, g	400
daily electric energy consumption, kWh	25,0
size of compression-condensation part	
width, mm	801
depth, mm	343
height, mm	744
size of evaporative section	
width, mm	804
depth, mm	433
height, mm	284

Logistic information

net, kg	54/17
gross, kg	106
packing width, mm	820
packing depth, mm	960
packing height, mm	870

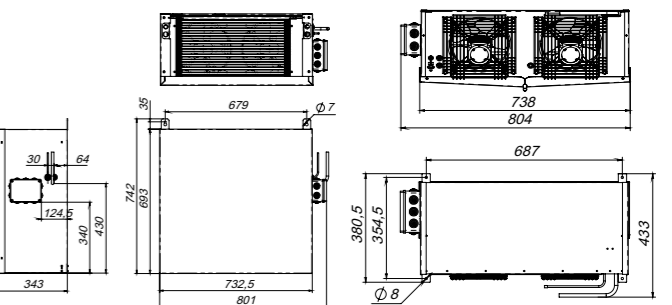
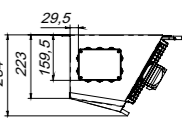



BEER COOLERS KEGERATORS

A beer cooler is a central element of equipment for selling beer. Beer from kegs through the beer lines gets into the cooler under pressure of carbon dioxide, and then the cooled beer through the beer lines gets into the beer column and gets into mugs, glasses, PET bottles via valves installed in the column or via PEGAS device.



BEER COOLER (4 CIRCUITS)

least beer effluent temperature,°C	3-5
chiller capacity, l/hr	138/70
energy consumption of the compressor kWh	0,28
width, mm	425
depth, mm	425
height, mm	660

Logistic information

net, kg	31
gross, kg	40
packing width, mm	530
packing depth, mm	490
packing height, mm	750



BEER COOLER (6 CIRCUITS)

least beer effluent temperature,°C	3-5
chiller capacity, l/hr	199/100
energy consumption of the compressor kWh	0,28
width, mm	425
depth, mm	425
height, mm	740

Logistic information

net, kg	36
gross, kg	45
packing width, mm	530
packing depth, mm	490
packing height, mm	850





REFRIGERATED COUNTERS

Medium-temperature refrigerated counters with refrigerated table. Counters for food markets for the sale of meat and fish products.

To demonstrate and sell fish and seafood, there are counters open on all sides, where the products are laid out on the scaly ice. That's why they're called «Fish on ice». Such counters allow presenting products in a more effective way, as well as preserving their marketable appearance and freshness.

Standard complete set:

- stainless steel countertop (0.8 mm);
- box with padlock hasp;
- additional stainless steel cash register table;
- Evco, Carelc electronic control unit with temperature indication and automatic defrosting mode;
- Danfoss or Tecumseh compressor (for integrated refrigeration supply);
- TPB Honeywell, Danfoss or Alco (for remote refrigeration supply);
- wooden packaging



PHS «FOR MEAT» 1,00/0,85	
cooled volume temperature,°C	0...-2
at ambient temperature,°C	+12...+25
display depth	100
refrigerated trays and shelves area, m²	0,42
useful refrigerated capacity, m³	
daily electric energy consumption, kWh	
width, mm	1000
depth, mm	955
height, mm	850

Logistic information	
net, kg	45
gross, kg	140
packing width, mm	1180
packing depth, mm	1140
packing height, mm	1090



PHS «FOR MEAT» 1,25/0,85	
cooled volume temperature,°C	0...-2
at ambient temperature,°C	+12...+25
display depth	100
refrigerated trays and shelves area, m²	0,55
useful refrigerated capacity, m³	
daily electric energy consumption, kWh	3,8-4,1
width, mm	1250
depth, mm	955
height, mm	850

Logistic information	
net, kg	97
gross, kg	161
packing width, mm	1430
packing depth, mm	1140
packing height, mm	1090

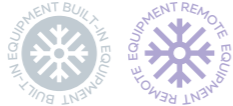

PHS «FOR MEAT» 1,55/0,85	
cooled volume temperature,°C	0...-2
at ambient temperature,°C	+12...+25
display depth	100
refrigerated trays and shelves area, m²	0,75
useful refrigerated capacity, m³	
daily electric energy consumption, kWh	3,8-4,1
width, mm	1550
depth, mm	955
height, mm	850

Logistic information	
net, kg	90
gross, kg	163
packing width, mm	1730
packing depth, mm	1140
packing height, mm	1090



PHS «FISH ON ICE» 1,55/0,85	
cooled volume temperature,°C	0...-2
at ambient temperature,°C	+12...+25
display depth	100
refrigerated trays and shelves area, m²	1,1
useful refrigerated capacity, m³	
daily electric energy consumption, kWh	3,7
width, mm	1550
depth, mm	860
height, mm	972

Logistic information	
net, kg	80
gross, kg	156
packing width, mm	1730
packing depth, mm	1040
packing height, mm	1180



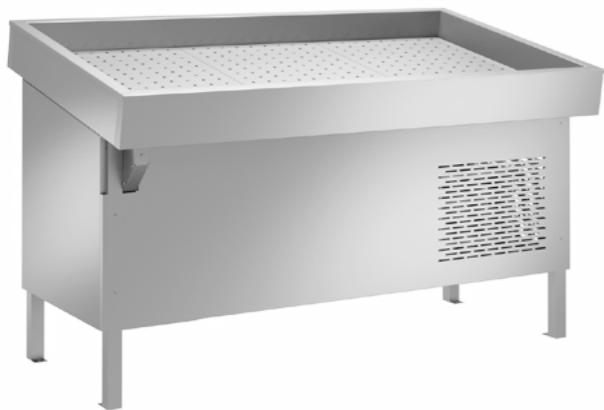

PHS «FISH ON ICE»		1,55/1,05
cooled volume temperature, °C		0...-2
at ambient temperature, °C		+12...+25
display depth		100
refrigerated trays and shelves area, m²		1,5
useful refrigerated capacity, m³		
daily electric energy consumption, kWh		3,7
width, mm		1550
depth, mm		1100
height, mm		972

Logistic information

net, kg	125
gross, kg	206
packing width, mm	1730
packing depth, mm	1280
packing height, mm	1180





COLD
ACKNOWLEDGED
BY TIME

MXM
m a r i k h o l o d m a s h

«Contact», JSC
133 Karla Marksa Street Yoshkar-Ola,
the Republic of Mari El, 424026
phone: + 7 (8362) 45-08-95, 45-06-70, 45-27-90
zavod@mariholod.com

 mariholod.com

 [mariholodmash.official](https://www.instagram.com/mariholodmash.official)